

One World Trade Center



Entire 65th Floor

Sq. Ft.: 33,500 RSF
3,112 SQM

Type: Office

Vesey Street

- AVAILABLE
- MECHANICAL
- ELEVATORS

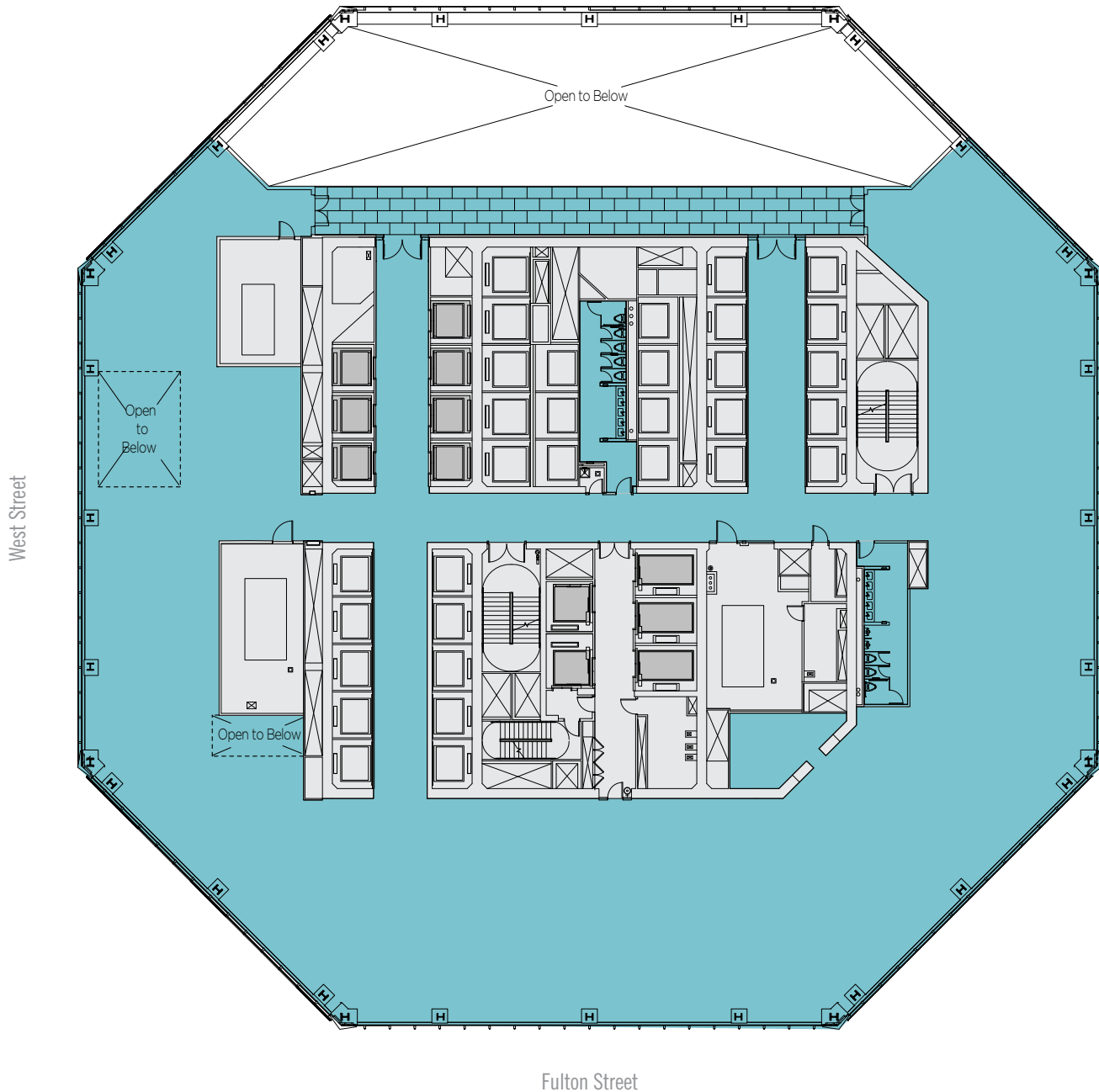

The Durst Organization
One World Trade Center
Suite 45E
New York, NY 10007

Primary Property Contacts:

Eric Engelhardt	212.667.8704	EEngelhardt@durst.org
Karen Kuznick	212.667.8705	KKuznick@durst.org
David A. Falk	212.372.2271	DFalk@ngkf.com

Leasing Group:

Jason T. Greenstein	212.372.2349	JGreenstein@ngkf.com
Andrew M. Peretz	212.233.8164	APeretz@ngkf.com
Peter T. Shimkin	212.372.2150	PShimkin@ngkf.com
Hal D. Stein	212.233.8185	HStein@ngkf.com
Travis Wilson	212.233.8167	TRWilson@ngkf.com