

# One World Trade Center



## Entire 71<sup>st</sup> Floor

Sq. Ft.: 40,907 RSF  
3,800 SQM

Type: Office

Vesey Street

- AVAILABLE
- MECHANICAL
- ELEVATORS

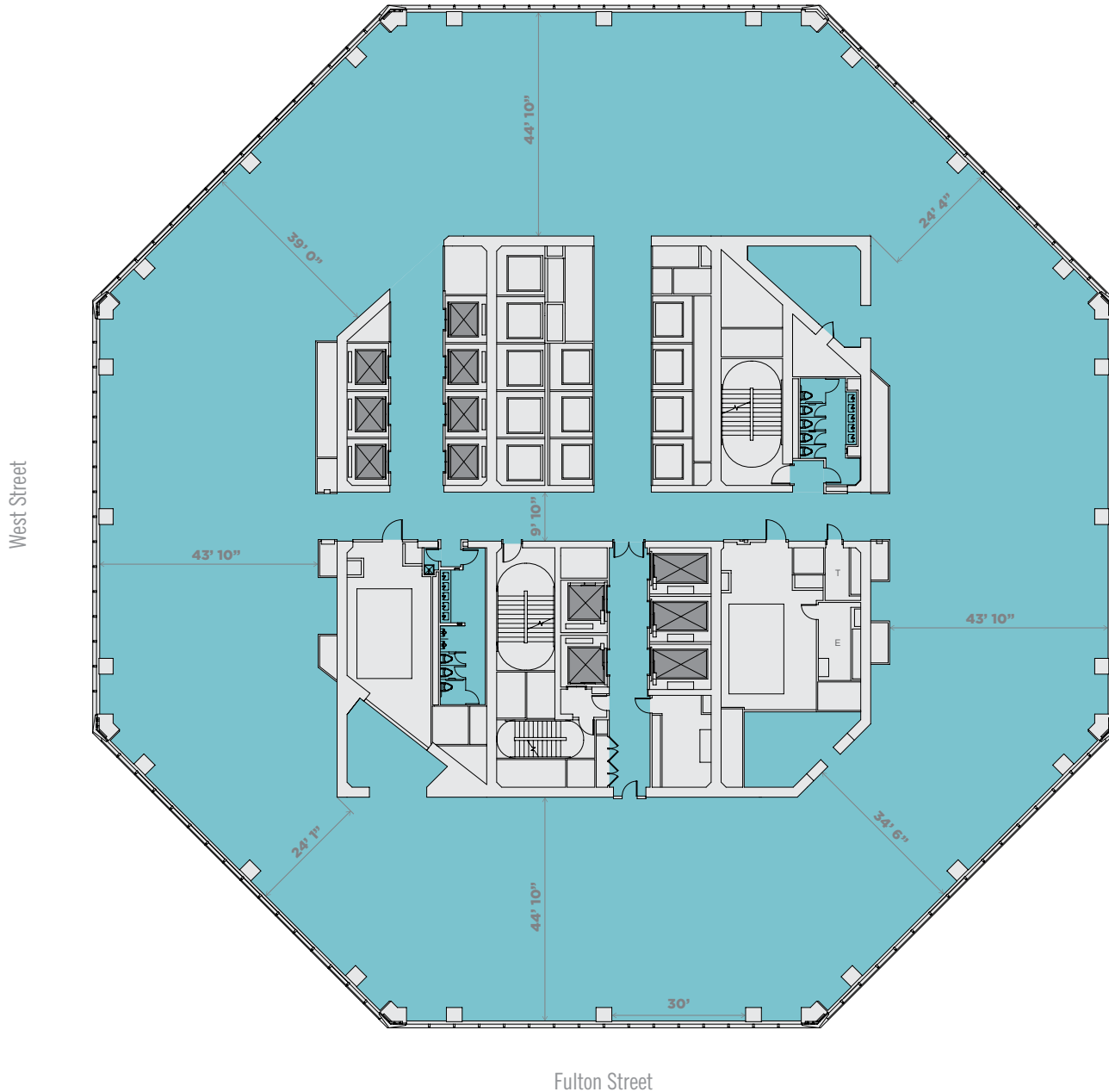

**The Durst Organization**  
One World Trade Center  
Suite 45E  
New York, NY 10007

Primary Property Contacts:

|                        |              |                       |
|------------------------|--------------|-----------------------|
| <b>Eric Engelhardt</b> | 212.667.8704 | EEngelhardt@durst.org |
| <b>Karen Kuznick</b>   | 212.667.8705 | KKuznick@durst.org    |
| <b>David A. Falk</b>   | 212.372.2271 | DFalk@ngkf.com        |

Leasing Group:

|                            |              |                      |
|----------------------------|--------------|----------------------|
| <b>Jason T. Greenstein</b> | 212.372.2349 | JGreenstein@ngkf.com |
| <b>Andrew M. Peretz</b>    | 212.233.8164 | APeretz@ngkf.com     |
| <b>Peter T. Shimkin</b>    | 212.372.2150 | PShimkin@ngkf.com    |
| <b>Hal D. Stein</b>        | 212.233.8185 | HStein@ngkf.com      |
| <b>Travis Wilson</b>       | 212.233.8167 | TRWilson@ngkf.com    |